

Millions in Use!

Envirowall Panel Clip

LEAF-SPRING CLIP ADVANTAGES

COMMERCIAL SIZE spring steel hardware, designed by and for the demanding journeyman installers.

SCREW SLOT allows wallboard panels to automatically correct normal screw run-off. This guarantees **hair-line tight** joints.

LEAF-SPRING FLANGE distorts after installation, causing a **lock-washer** force that retains all panels under tension for **rock solid, rattle-proof walls**.

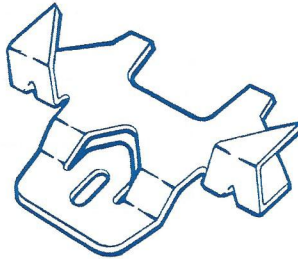

WIDE STANCE distributes holding power and **eliminates** panel fracture.

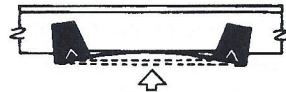

DIVERGENT POINTS make the clips **gull-wing** flat against the panel for perfect registry, even with less skilled installers. Absolutely flat, **shadow proof** joints are guaranteed.

Simple as 1

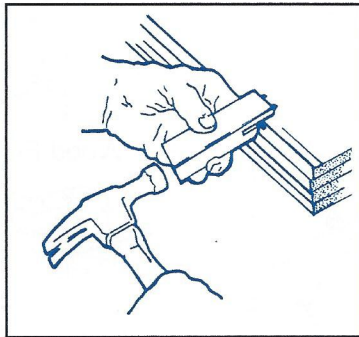

INSERT a few clips into each panel edge with the magnetic tool provided.



ERECT panels and fasten with Ultra-low Clip Screws. (Included with the Clips)

2

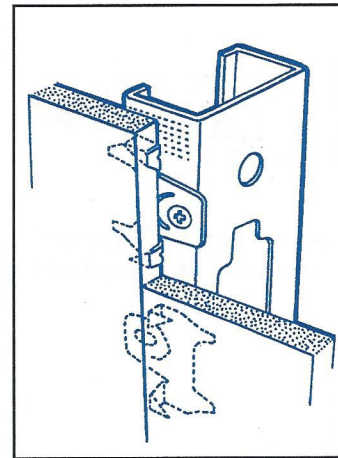

SLIDE the next panel clips behind for rock solid tongue & groove joints.

3

© 2011 CYMAX SYSTEMS INC

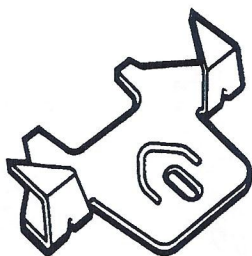

Environwall Panel Clip

ENVIROWALL
PARTITION SYSTEMS LIMITED

PACKAGING

Environwall Hardware is packaged 1000 Clips per Carton, Carton will install about 100 (4x8) Panels.

All Hardware includes Ultra-Low Screws, a Magnetic Clip Driver Tool and Instructions.



Ultra-Low Screws for use on Wood or Metal Framing.

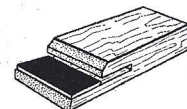

Envirowall Panel Clip

INSTALLATION

1

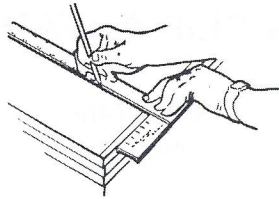

Trim Envirowall Panel to proper height.
Layout back of panel by drawing Layout marks at 16" (400mm) intervals
(Marks can be carried down sides of Stacked panels with a chalk line)

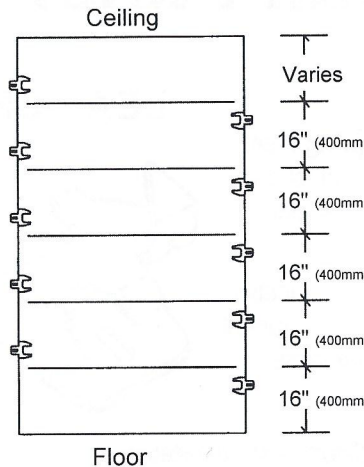

Locate clips above the line on one side and below on the opposite side.
(Staggered clip layout creates a tongue & groove panel joint)

2

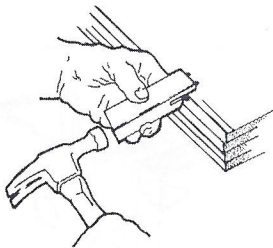

Seat the clips with the Magnetic Clip Driver
(Use care not to damage panel edge)

3

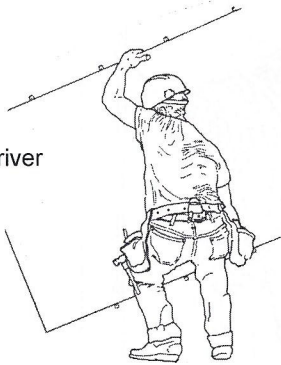

Position panel (with clips installed) on any wood or metal framing.
Tighten the joint. with floor leverage tool .
Screw to floor and ceiling track with ordinary drywall screws.

4

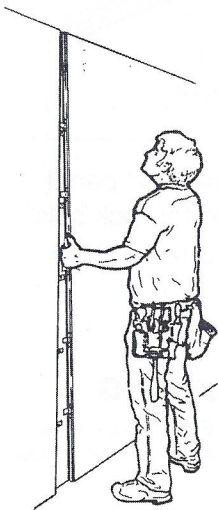

The clips on the next panel simply slide behind the fixed panel.

(Clips have patented leaf-Spring flanges so partitions have rock solid "Lock-washer" joints)

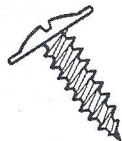

Use low-profile screws to secure one series of clips.
(Only one side of each panel is directly screw fastened)



A few adhesive dabs on center studs can correct bowed panels and stiffen the wall.

Stagger joints on opposite sides of the wall when possible.

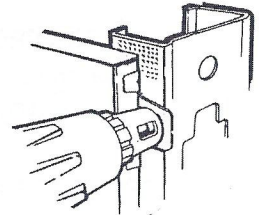
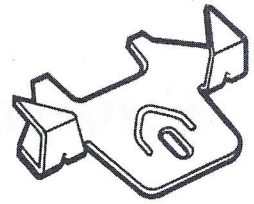

Steel Stud

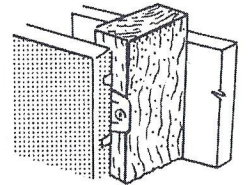

Wood Stud

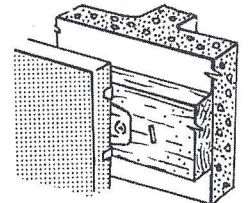

Wood Furring

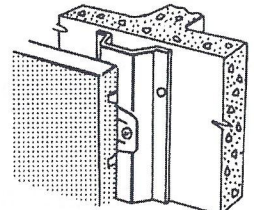

Steel Furring

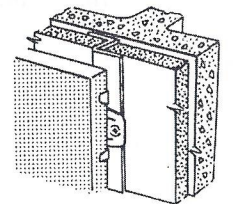

Z-Metal Furring

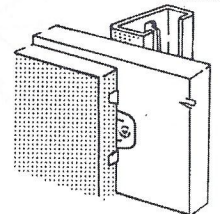

Double Wall

ENVIROWALL
PARTITION SYSTEMS LIMITED